



tile & stone Installation Systems

ARDEX Products Assembly

1. Grout Options:

- A. ARDEX FL™ Rapid Set, Flexible Sanded Grout
- B. ARDEX FG-C™ MICROTEC® Unsanded Grout

2. Latex-Portland Cement Options:

- A. ARDEX X 77™ MICROTEC® Fiber Reinforced Thin Set Mortar
- B. ARDEX X 32™ MICROTEC® Fiber Reinforced Rapid Setting Thin-to-Thick Bed Mortar

3. Waterproofing Membrane:

- A. ARDEX 8+9™ Waterproofing and Crack Isolation Compound

4. Mortar Bed:

- A. A38 Mix OR EB2

5. Roof Deck Membrane

By Others

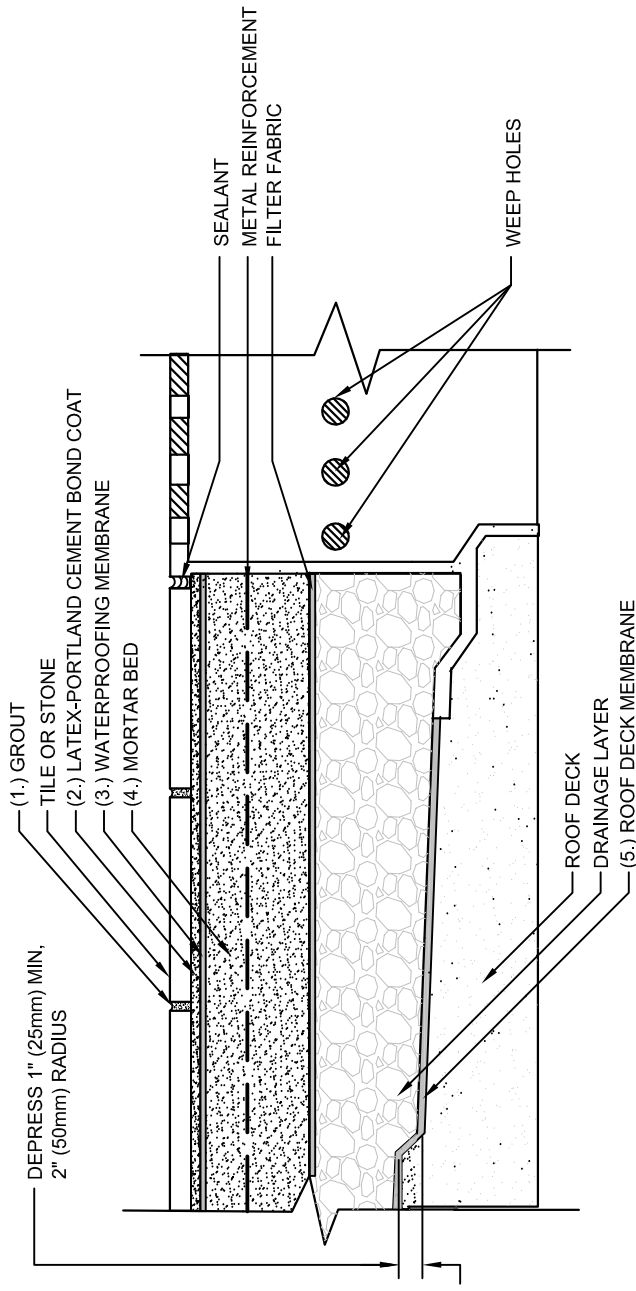

Scale: N.T.S.

Drawings are developed to be compatible with Tile Council of North America 2013 TCNA Handbook for Ceramic, Glass and Stone Tile Installation.

ARDEX products are listed as options and are substituted for TCA's and TTMAC's listed ANSI and ISO 13007 standards. Please refer to the Tile Council of North America 2013 TCNA Handbook for Ceramic, Glass and Stone Tile Installation for complete instructions and application limitations.

Some installation methods and component materials are not referenced. ARDEX Americas encourages the user to consult all approved resources to ensure a complete assembly.

ARDEX Americas
400 Ardex Park Drive
Alliquippa, PA 15001

Technical Services:
1-800-512-7339
www.ardexamericas.com

SystemOne™

Floors, Exterior
Roof Deck, (over occupied space)
Membrane, Cement Mortar

AF103
TCNA: F103
TTMAC: 325ED-E